

SUMMARY

By THE CANADIAN PRESS
Toronto: Market higher, trading heavy.
New York: Market mixed, trading moderately heavy.

NEW YORK

NEW YORK (AP)—A prolonged stock market advance paused for breath Thursday and the final price pattern was scrambled.
As the upward drive—which has carried averages to historic heights in the previous three days—ran out of gas, the pace of trading slowed.

Volume sank to 5,870,000 shares from 6,560,000 Wednesday.

The Dow Jones average ended with a decline of .95 at 911.91.

The most active stock was Colorado Fuel and Iron, which rose 1/4 to 15 1/4 on 116,200 shares.

General Motors opened at its peak of 108 1/2 but ended with a net loss of 1/2.

Canadian Pacific dropped 1 1/2 points among Canadians. Dome Mines was down 1/2.

Prices were generally higher on the American Stock Exchange. Canadian Javelin advanced 1/2.

What stocks did:
Thu Wed
Advances 376 405
Declines 516 497

Unchanged 278 272
Total issues 1,384 1,374

NEW YORK CLOSING STOCKS
By The Associated Press

Both Steel 28 1/2
Borg Warner 51 1/2
C and O 6 1/2

Radio Corp 8 1/2
Cons Edgco 4 1/2
Gen Elec 10 1/2

Westing 10 1/2
Int T T 5 1/2
Kennedy 10 1/2

MONTREAL (CP)—Banks eased against the general trend Thursday on the Montreal and Canadian stock exchanges.

Trade was moderate. Industrial volume was 234,100 shares and mines and oil 1,495,900.

Industrial prices were up 0.4 to 172.1, a high. Canada Cement added 1/4 to 58 1/2.

Utilities up 0.1 to 154.3. Bell Telephone 3/4 to 61 1/2.

Interprovincial Pipe Line 1/2 to 91. C.P.R. dropped 1 1/2 points to 65 1/2.

Papers up 0.9 to 147.4, a high. Consolidated 3/4 to 46 and MacMillan Bloedel 1/2 to 38.

Senior oils were higher, up 1/2 to 55. Haskay 1/2 to 13 1/2.

Metals were mixed. In the base section, Hudson Bay Mining dropped 1/2 to 75.

Trade and finance issues were up with Steinberg's adding 3/4 to 47 1/2.

Bank stocks edged up. Bank Montreal 1/2 to 22 1/2.

Among speculative mines, Jubilee Iron climbed 44 cents to \$2.49.

Equity Explorations was off one cent to 66 cents with a turnover of 487,970 shares.

Northern Explorations dropped 10 cents to 17 1/2.

Complete tabulation of Thursday transactions. Quotations in cents unless marked.

Bank Montreal 22 1/2
Bank Toronto 22 1/2
Bank of Montreal 22 1/2

Bank of Nova Scotia 22 1/2
Bank of New Brunswick 22 1/2
Bank of Prince Edward 22 1/2

Bank of St. John's 22 1/2
Bank of the Atlantic 22 1/2
Bank of the Maritimes 22 1/2

Bank of the Gulf 22 1/2
Bank of the West 22 1/2
Bank of the North 22 1/2

PRODUCE

MONTREAL (CP)—Agricultural department quotations; Eggs: Wholesale prices to country stations.

Extra-large 28-30 1/2; large 26-28 1/2; medium 24-26 1/2; small 22-24 1/2.

Butter: Current receipts non-tenderable 52 1/2. Wholesale solids non-tenderable 53 1/2.

Cheese: Delivered Montreal, waxed, current receipts wholesale Quebec white 38; colored 38.

Skim milk powder: Spray process No. 1 in bags 15-16; feed 13-13 1/2.

Potatoes: Wholesale selling price, new N.B. 50s 2.40-2.50; 10s 35-37; P.E.I. 75s 2.45-4.00.

White Star 1.60-1.80; 2.00-2.10; 2.20-2.30; 2.40-2.50.

Total Sales: Industrial 294,100, mines and oil 1,495,900.

TORONTO

TORONTO (CP)—Speculative oils and industrials were higher in heavy stock exchange trading Thursday.

Banff Oil led penny oils, reaching a high of \$8.25 on 180,594 shares.

Dynamic Petroleum traded over 444,000 shares and fetched 77 1/2 cents.

Mill City rose 3 to 65 cents on 126,730 shares and Western Decalla 23 cents to \$3.20 on 38,924 shares.

In penny mines, Heald gained a penny to 9 1/2 cents on 160,000 shares.

Chib and Kayrand churned up 210,360 shares and added 2 to 28 cents.

Consolidated Helkeno rose 2 1/2 to 16 1/2 cents on 293,633 shares.

Textmont gained 12 cents to \$1.87.

Industrial gains were widespread. Algoma Steel and Jefferson Lake Petrochemicals gained 1/4 at 81 and 16 1/2.

Interprovincial Pipe rose 1/4 to 91. Sileco rose 1/4 to 33 1/2 after hitting a high of 34 1/2 on 18,380 shares.

Dofasco and Guaranty Trust each rose 1/4 to 29 1/2 and 67 1/2.

Hudson Bay fell 1/4 to 75 among senior base metals and Cominco rose 3/4 to 46 1/2.

Gold was quiet. Industrials rose 3/4 to a high of 175.73.

The TSE index 32 to a record 164.99 and Western oils 52 to a high of 100.10.

Gold fell 50 to 164.10 and base metals gained 1/4 to 82.97.

Volume was 4,973,000 shares compared with 5,605,000.

TORONTO CLOSING STOCKS
By The Canadian Press

Complete tabulation of Thursday transactions. Quotations in cents unless marked.

Bank of Montreal 22 1/2
Bank of Toronto 22 1/2
Bank of Nova Scotia 22 1/2

Bank of New Brunswick 22 1/2
Bank of Prince Edward 22 1/2
Bank of St. John's 22 1/2

Bank of the Atlantic 22 1/2
Bank of the Maritimes 22 1/2
Bank of the Gulf 22 1/2

Bank of the West 22 1/2
Bank of the North 22 1/2
Bank of the South 22 1/2

Bank of the East 22 1/2
Bank of the Central 22 1/2
Bank of the West 22 1/2

Bank of the North 22 1/2
Bank of the South 22 1/2
Bank of the East 22 1/2

Bank of the West 22 1/2
Bank of the North 22 1/2
Bank of the South 22 1/2

Bank of the East 22 1/2
Bank of the Central 22 1/2
Bank of the West 22 1/2

Bank of the North 22 1/2
Bank of the South 22 1/2
Bank of the East 22 1/2

Goldray 1180 3/2
Grandeur 13430 3/2
Grandeur 3380 7/2
Gulf L 1800 1/2

Hard Rock 1500 1/2
Hasego 500 1/2
Hastings 2500 1/2
Headway 2500 1/2

High Bell 1600 1/2
Hollinger 225 1/2
Hud Bay 1800 1/2
Int Ribbia 500 1/2

J. Kenway 500 1/2
K. Ray 2000 1/2
K. Ray 2000 1/2
K. Ray 2000 1/2

K. Ray 2000 1/2
K. Ray 2000 1/2
K. Ray 2000 1/2
K. Ray 2000 1/2

K. Ray 2000 1/2
K. Ray 2000 1/2
K. Ray 2000 1/2
K. Ray 2000 1/2

K. Ray 2000 1/2
K. Ray 2000 1/2
K. Ray 2000 1/2
K. Ray 2000 1/2

K. Ray 2000 1/2
K. Ray 2000 1/2
K. Ray 2000 1/2
K. Ray 2000 1/2

K. Ray 2000 1/2
K. Ray 2000 1/2
K. Ray 2000 1/2
K. Ray 2000 1/2

K. Ray 2000 1/2
K. Ray 2000 1/2
K. Ray 2000 1/2
K. Ray 2000 1/2

K. Ray 2000 1/2
K. Ray 2000 1/2
K. Ray 2000 1/2
K. Ray 2000 1/2

K. Ray 2000 1/2
K. Ray 2000 1/2
K. Ray 2000 1/2
K. Ray 2000 1/2

K. Ray 2000 1/2
K. Ray 2000 1/2
K. Ray 2000 1/2
K. Ray 2000 1/2

K. Ray 2000 1/2
K. Ray 2000 1/2
K. Ray 2000 1/2
K. Ray 2000 1/2

K. Ray 2000 1/2
K. Ray 2000 1/2
K. Ray 2000 1/2
K. Ray 2000 1/2

K. Ray 2000 1/2
K. Ray 2000 1/2
K. Ray 2000 1/2
K. Ray 2000 1/2

K. Ray 2000 1/2
K. Ray 2000 1/2
K. Ray 2000 1/2
K. Ray 2000 1/2

K. Ray 2000 1/2
K. Ray 2000 1/2
K. Ray 2000 1/2
K. Ray 2000 1/2

K. Ray 2000 1/2
K. Ray 2000 1/2
K. Ray 2000 1/2
K. Ray 2000 1/2

K. Ray 2000 1/2
K. Ray 2000 1/2
K. Ray 2000 1/2
K. Ray 2000 1/2

K. Ray 2000 1/2
K. Ray 2000 1/2
K. Ray 2000 1/2
K. Ray 2000 1/2

K. Ray 2000 1/2
K. Ray 2000 1/2
K. Ray 2000 1/2
K. Ray 2000 1/2

K. Ray 2000 1/2
K. Ray 2000 1/2
K. Ray 2000 1/2
K. Ray 2000 1/2

K. Ray 2000 1/2
K. Ray 2000 1/2
K. Ray 2000 1/2
K. Ray 2000 1/2

K. Ray 2000 1/2
K. Ray 2000 1/2
K. Ray 2000 1/2
K. Ray 2000 1/2

K. Ray 2000 1/2
K. Ray 2000 1/2
K. Ray 2000 1/2
K. Ray 2000 1/2

K. Ray 2000 1/2
K. Ray 2000 1/2
K. Ray 2000 1/2
K. Ray 2000 1/2

K. Ray 2000 1/2
K. Ray 2000 1/2
K. Ray 2000 1/2
K. Ray 2000 1/2

K. Ray 2000 1/2
K. Ray 2000 1/2
K. Ray 2000 1/2
K. Ray 2000 1/2

K. Ray 2000 1/2
K. Ray 2000 1/2
K. Ray 2000 1/2
K. Ray 2000 1/2

K. Ray 2000 1/2
K. Ray 2000 1/2
K. Ray 2000 1/2
K. Ray 2000 1/2

MONTREAL (CP)—Cattle prices were steady to 25 cents higher and calves uneven.

Receipts: 1,117 cattle; 2,690 calves; 483 hogs; 196 sheep and lambs.

Choice steers 24.10-24.25; good 23.10-23.75; medium 22.75-23.10.

Good heifers 21.25; medium 18.20-25; common 11-18.

Good cows 15.15-30; few to 17; medium 13.50-15.50; common 11.50-14.50.

Good bulls 17.50-21.25; common and medium 10-17.75.

Good weaners 24-29; tops 30.50; medium 18-25; common 10-19.

Hogs grade A 27-28; sows 18-19.

Spring lambs 30.50-35 for ritual slaughter; few good sheep 10-14; common 8.

First Aid For Ailing Houses
By ROGER C. WHITMAN

NEW FLOOR DUSTY
QUESTION: We moved into our just-finished house about a year ago.

ANSWER: This condition is easily remedied. Applying several thin coats of good quality paste wax.

QUESTION: Our house is a ranch-type on a concrete slab over a low crawl space.

ANSWER: Yes. Laminated oak block is now available for installation on concrete slabs.

QUESTION: I am interested in making one of those wood benches having a high back.

ANSWER: I think you are referring to what is known as a larch bench.

QUESTION: I have a small vacation cottage and am bothered by a lot of small ants in the kitchen.

ANSWER: Glad to report yes! A liquid, self-polishing wax, containing insecticide.

QUESTION: The provincial market, continuing to show strength, rose 5 1/2 per cent.

QUESTION: The corporate market was firm in quiet trading.

QUESTION: How are asbestos shingles cut to fit where necessary?

ANSWER: Score the asbestos shingle along the line to be cut with a carbide-tipped blade.

QUESTION: I have some left-over living room wallpaper, which I would like to use to replace some badly worn-off areas.

ANSWER: Do not cut the patch so that it will have a sharp line. Tear the paper from the back.

QUESTION: I have some left-over living room wallpaper, which I would like to use to replace some badly worn-off areas.

ANSWER: Do not cut the patch so that it will have a sharp line. Tear the paper from the back.

QUESTION: I have some left-over living room wallpaper, which I would like to use to replace some badly worn-off areas.

ANSWER: Do not cut the patch so that it will have a sharp line. Tear the paper from the back.

QUESTION: I have some left-over living room wallpaper, which I would like to use to replace some badly worn-off areas.

ANSWER: Do not cut the patch so that it will have a sharp line. Tear the paper from the back.

QUESTION: I have some left-over living room wallpaper, which I would like to use to replace some badly worn-off areas.

ANSWER: Do not cut the patch so that it will have a sharp line. Tear the paper from the back.

QUESTION: I have some left-over living room wallpaper, which I would like to use to replace some badly worn-off areas.

ANSWER: Do not cut the patch so that it will have a sharp line. Tear the paper from the back.

QUESTION: I have some left-over living room wallpaper, which I would like to use to replace some badly worn-off areas.

ANSWER: Do not cut the patch so that it will have a sharp line. Tear the paper from the back.

QUESTION: I have some left-over living room wallpaper, which I would like to use to replace some badly worn-off areas.

Large kitchen is convenient to side door, basement and the protected front entrance.

The living room features vented picture window, and door to terrace and garden. Sleeping area comprises two bedrooms.

Without the garage house could be built on a 50 foot lot, or on 60 feet with a single garage.

Construction is brick veneer with vertical board accent. Design suitable for electric heating, 1116 Sq. Ft.

WHAT'S IN A HOUSE
Erecting Foundation, Handling Concrete

FOUNDATION WALLS
As soon as sufficient strength has developed in the concrete of the footings to support the loads, work should commence on the foundation walls and columns.

Before placing concrete the subgrade should be properly prepared and the forms should be erected true to line and adequately braced.

With poured concrete walls, the concrete should be placed with uniformity in uniformly aligned forms.

Basement walls should be braced against deflection. Basement window frames or rough blocks should be installed in the forms prior to placing the concrete.

With concrete block foundation walls the masonry units must be of a load bearing type and the top course should be filled with mortar.

Below grade the unit masonry wall should be parged with 1/2" cement mortar. Both types of wall should be water proofed below grade with asphalt emulsion.

QUESTION: I am interested in making one of those wood benches having a high back.

ANSWER: I think you are referring to what is known as a larch bench. Detailed plans for making a Colonial Hutch Table.

QUESTION: The provincial market, continuing to show strength, rose 5 1/2 per cent.

QUESTION: The corporate market was firm in quiet trading.

QUESTION: How are asbestos shingles cut to fit where necessary?

ANSWER: Score the asbestos shingle along the line to be cut with a carbide-tipped blade.

QUESTION: I have some left-over living room wallpaper, which I would like to use to replace some badly worn-off areas.

ANSWER: Do not cut the patch so that it will have a sharp line. Tear the paper from the back.

QUESTION: I have some left-over living room wallpaper, which I would like to use to replace some badly worn-off areas.

ANSWER: Do not cut the patch so that it will have a sharp line. Tear the paper from the back.

QUESTION: I have some left-over living room wallpaper, which I would like to use to replace some badly worn-off areas.

ANSWER: Do not cut the patch so that it will have a sharp line. Tear the paper from the back.

QUESTION: I have some left-over living room wallpaper, which I would like to use to replace some badly worn-off areas.

ANSWER: Do not cut the patch so that it will have a sharp line. Tear the paper from the back.

QUESTION: I have some left-over living room wallpaper, which I would like to use to replace some badly worn-off areas.

ANSWER: Do not cut the patch so that it will have a sharp line. Tear the paper from the back.

QUESTION: I have some left-over living room wallpaper, which I would like to use to replace some badly worn-off areas.

ANSWER: Do not cut the patch so that it will have a sharp line. Tear the paper from the back.

QUESTION: I have some left-over living room wallpaper, which I would like to use to replace some badly worn-off areas.

ANSWER: Do not cut the patch so that it will have a sharp line. Tear the paper from the back.

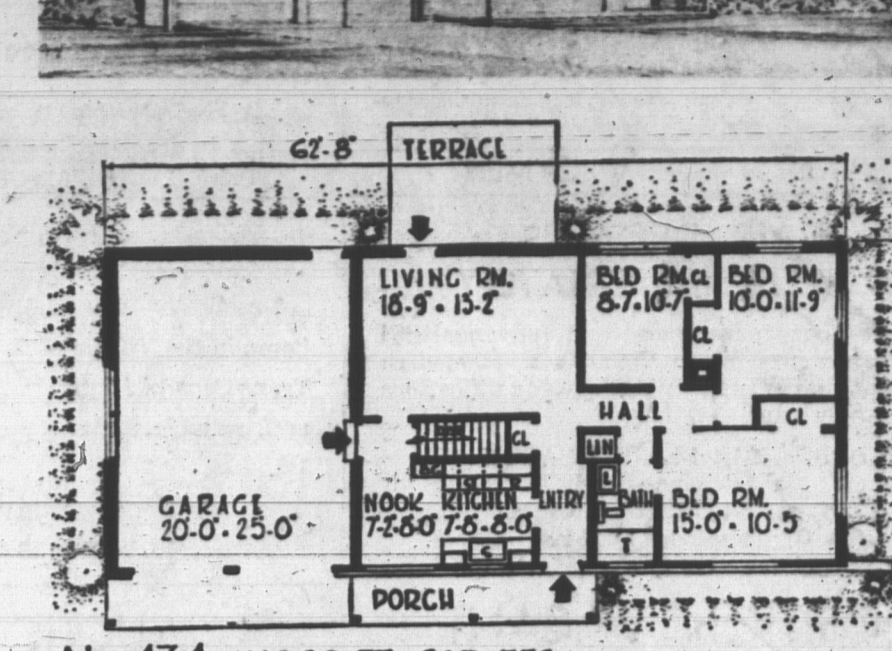

No-434 1116 SQ. FT. GAR. 556

HOW TO OBTAIN DESIGN BOOK
The latest design book entitled "Canadian Guide to Home Planning and Design is now available at the offices of The Guardian and The Evening Patriot for \$1 tax free.

WHAT'S IN A HOUSE
Erecting Foundation, Handling Concrete

FOUNDATION WALLS
As soon as sufficient strength has developed in the concrete of the footings to support the loads, work should commence on the foundation walls and columns.

Before placing concrete the subgrade should be properly prepared and the forms should be erected true to line and adequately braced.

With poured concrete walls, the concrete should be placed with uniformity in uniformly aligned forms.

Basement walls should be braced against deflection. Basement window frames or rough blocks should be installed in the forms prior to placing the concrete.

With concrete block foundation walls the masonry units must be of a load bearing type and the top course should be filled with mortar.

Below grade the unit masonry wall should be parged with 1/2" cement mortar. Both types of wall should be water proofed below grade with asphalt emulsion.

QUESTION: I am interested in making one of those wood benches having a high back.

ANSWER: I think you are referring to what is known as a larch bench. Detailed plans for making a Colonial Hutch Table.

QUESTION: The provincial market, continuing to show strength, rose 5 1/2 per cent.

QUESTION: The corporate market was firm in quiet trading.

QUESTION: How are asbestos shingles cut to fit where necessary?

ANSWER: Score the asbestos shingle along the line to be cut with a carbide-tipped blade.

QUESTION: I have some left-over living room wallpaper, which I would like to use to replace some badly worn-off areas.

ANSWER: Do not cut the patch so that it will have a sharp line. Tear the paper from the back.

QUESTION: I have some left-over living room wallpaper, which I would like to use to replace some badly worn-off areas.

ANSWER: Do not cut the patch so that it will have a sharp line. Tear the paper from the back.

QUESTION: I have some left-over living room wallpaper, which I would like to use to replace some badly worn-off areas.

ANSWER: Do not cut the patch so that it will have a sharp line. Tear the paper from the back.

QUESTION: I have some left-over living room wallpaper, which I would like to use to replace some badly worn-off areas.

ANSWER: Do not cut the patch so that it will have a sharp line. Tear the paper from the back.

QUESTION: I have some left-over living room wallpaper, which I would like to use to replace